

THE INVERCLYDE COUNCIL
(VARIOUS ROADS) (INNER GREENOCK)
(CONTROLLED PARKING ZONE)
(VARIATION NO. 5) ORDER 2015

TRAFFIC REGULATION ORDER

**THE INVERCLYDE COUNCIL
(VARIOUS ROADS) (INNER GREENOCK)
(CONTROLLED PARKING ZONE) (VARIATION NO. 5) ORDER 2015**

We, The Inverclyde Council in exercise of the powers conferred on us by Sections 1(1), 2(1) to (3), 4(2), 32(1), 35(1), 45, 46, 49, 53, 101 and 102 of the Road Traffic Regulation Act 1984 (as amended) ("the Act") and of Part IV of Schedule 9 to the Act and of all other enabling powers and after consulting the Chief Constable of the Police Service of Scotland (Seirbheis Phoilis na h-Alba) in accordance with Part III of Schedule 9 to the Act hereby make the following Order:

1.0 Commencement and citation

1.1 This Order shall come into operation on the Twenty Fifth day of April, Two Thousand and Sixteen and may be cited as "The Inverclyde Council (Various Roads) (Inner Greenock) (Controlled Parking Zone) (Variation No. 5) Order 2015".

2.0 Interpretation

2.1 In this Order except where the context otherwise requires, the following expressions have the meanings hereby respectively assigned to them:

"End Date" means the date on which the particulars of a Printed Permit or a Virtual Permit retained on the Telephone Parking System are removed from the Telephone Parking System;

"Hand-held Device" means apparatus used by a Parking Attendant, an Authorised Person or a police constable in uniform which is programmed to interface with the Telephone Parking System;

"Identification Code" means a combination of letters and numerals by which the Council identifies an Inner Greenock Controlled Parking Zone;

"Inner Greenock Controlled Parking Zone, also referred to as Zone GR1" means any road or part of a road within the boundary of the Inner Greenock Controlled Parking Zone, also referred to as Zone GR1, specified in the maps forming Schedule 1 to this Order;

"Permit" means a Printed Permit or a Virtual Permit issued by the Council in accordance with the Permit scheme set out in this Order;

"Printed Permit" means a document specified in Article 4.3 of this Order which may be issued by the Council and if so issued shall be displayed and used in accordance with the particulars stipulated thereon;

"Residents' Parking Permit" means a Printed Permit or a Virtual Permit issued by the Council, in accordance with the provisions of Article 3.0 of this Order, at such a charge and on such terms and conditions as the Council may determine;

"Service Provider" means a person or company providing services to or on behalf of the Council;

“Start Date” means the date on which the particulars of a Printed Permit or a Virtual Permit are entered on the Telephone Parking System;

“Telephone Parking System” means a system to facilitate and monitor any Permits, whether Virtual Permits or Printed Permits, using any telephone or internet enabled device via communication with the Service Provider; and

“Virtual Permit” means a Permit which is not a Printed Permit, which is specified in Article 4.2 of this Order and which may be issued by the Council.

- 2.2 Except where otherwise stated, any reference in this Order to a numbered Article or Schedule is a reference to the Article or Schedule bearing that number in this Order.
- 2.3 Any reference in this Order to any enactment shall be construed as a reference to that enactment as amended, modified, re-enacted, replaced or supplemented by any subsequent enactment.
- 2.4 The prohibitions and restrictions imposed by this Order shall be in addition to and not in derogation from any restriction or requirement imposed by any regulation made or having effect as if made under the Act or by or under any other enactment provided that where a prohibition or restriction which is imposed, varied or revoked by this Order is in conflict with a prohibition or restriction imposed by a previous Order, then the provision of this Order shall prevail.
- 2.4 The On-Street Plans forming Schedule 1 to this Order and titled “The Inverclyde Council (Various Roads) (Inner Greenock) (Controlled Parking Zone) (Variation No. 5) Order 2015 On-Street Plans” are hereby incorporated into The Inverclyde Council (Various Roads) (Inner Greenock) (Controlled Parking Zone) Order 2013 and recorded in “The Inverclyde Council (Various Roads) (Inner Greenock) (Controlled Parking Zone) Order 2013 Plan Index”.
- 2.5 The Plan Index forms Schedule 2.
- 2.6 The Interpretation Act 1978 (as amended) shall apply for the interpretation of this Order as it applies for the interpretation of an Act of Parliament.
- 3.0 **Residents’ Parking Permit**
- 3.1 The Council may issue Residents’ Parking Permits, at such a charge and on such terms and conditions as the Council may determine, to a person who ordinarily resides in a dwelling house in any road within the boundary of the Inner Greenock Controlled Parking Zone, also referred to as Zone GR1, specified in the maps forming Schedule 1 to this Order.

4.0 Form of Permits

- 4.1 A Permit shall be either a Virtual Permit or a Printed Permit;
- 4.2 The following information shall be retained on the Telephone Parking System as an indication that a Virtual Permit has been granted:-
- (a) the name and address of the applicant;
 - (b) the name of the Inner Greenock Controlled Parking Zone in which the Virtual Permit is valid;
 - (c) the Identification Code of the Inner Greenock Controlled Parking Zone in which the Virtual Permit is valid;
 - (d) the Virtual Permit number;
 - (e) the registration number of the Motor Vehicle, Motor Cycle or Invalid Carriage in respect of which the Virtual Permit has been issued;
 - (f) the Start Date; and
 - (g) the End Date.
- 4.3 Where a Printed Permit is issued by the Council:-
- (a) it shall include the particulars listed in sub-paragraphs (b) to (g) of Article 4.2;
 - (b) it is not transferrable; and
 - (c) it shall remain the property of the Council at all times.

5.0 Use of Permits

- 5.1 A Permit shall be used only in accordance with the Permit scheme set out in this Article.
- 5.2 Subject to Article 5.1 a Permit may be used:-
- (a) within the Inner Greenock Controlled Parking Zone, also referred to as Zone GR1;
 - (b) in the case of a Virtual Permit, where the Motor Vehicle, Motor Cycle or Invalid Carriage has been recorded on the Telephone Parking System for that Virtual Permit; and
 - (c) in the case of a Printed Permit, where details of the Motor Vehicle, Motor Cycle or Invalid Carriage are the same as those recorded on the Printed Permit and the Printed Permit is displayed on the Motor Vehicle, Motor Cycle or Invalid Carriage in accordance with Article 6.1 hereof.
- 5.3 If at any time a Motor Vehicle, Motor Cycle or Invalid Carriage is left in a Limited Waiting Parking Place and an inspection is carried out by a Parking Attendant, an Authorised Person or a police constable in uniform, and no indication that a Permit has been granted in respect of that Motor Vehicle, Motor Cycle or Invalid Carriage for the Inner Greenock Controlled Parking Zone, also referred to as Zone GR1, appears on the Hand-held Device of a Parking Attendant, an Authorised Person or a police constable in uniform, it shall be presumed, unless the contrary is proved, that a Permit has not been granted for that Motor Vehicle, Motor Cycle or Invalid Carriage at the time of inspection.

- 5.4 A person holding a valid Inner Greenock Controlled Parking Zone, also referred to as Zone GR1, Residents' Parking Permit is permitted to wait in any Limited Waiting Parking Place on a road within the boundary of the Inner Greenock Controlled Parking Zone, also referred to as Zone GR1, specified in the maps forming Schedule 1 to this Order, without limit of time.
- 5.5 An Inner Greenock Controlled Parking Zone, also referred to as Zone GR1, Residents' Parking Permit shall not be valid in any Limited Waiting Parking Place other than on those roads within the boundary of the Inner Greenock Controlled Parking Zone, also referred to as Zone GR1, specified in the maps forming Schedule 1 to this Order.

6.0 Display of Printed Permits

- 6.1 Where a Printed Permit issued by the Council is used:-
- (a) in the case of a Motor Vehicle, the driver of any Motor Vehicle parked in any Limited Waiting Parking Place who wishes to make use of a Printed Permit shall attach or display the Printed Permit on the Motor Vehicle on the nearside thereof, behind the glass of the windscreen, in such position as to ensure that the front side of the Printed Permit is clearly visible to any person standing at the front nearside of the Motor Vehicle; and
 - (b) in the case of a Motor Cycle or Invalid Carriage, the driver of any Motor Cycle or Invalid Carriage parked in any Limited Waiting Parking Place who wishes to make use of a Printed Permit shall attach or display the Printed Permit on the Motor Cycle or Invalid Carriage in a conspicuous position in front of the driver's seat.
- 6.2 Where an inspection is carried out by a Parking Attendant, an Authorised Person or a police constable in uniform, and a Printed Permit issued in respect of that Motor Vehicle, Motor Cycle or Invalid Carriage is not displayed in accordance with Article 6.1 or the particulars shown on the Printed Permit indicate it has not yet commenced, it shall be deemed that a Printed Permit has not been issued in respect of that vehicle at the time of inspection.

7.0 Duration of Permits

- 7.1 A Permit shall be valid from the Start Date retained on the Telephone Parking System for one calendar year or, if earlier, until such time as it is revoked or cancelled by the Council.

This Order and the two Schedules annexed hereto are sealed with the Common Seal of The Inverclyde Council and subscribed for them and on their behalf by Gerard Joseph Malone, Proper Officer and an authorised signatory at Greenock on the Tenth day of March Two Thousand and Sixteen.

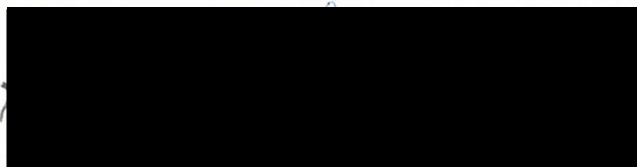

SCHEDULE 1

The Inverclyde Council (Various Roads) (Inner Greenock) (Controlled Parking Zone) (Variation No. 5) Order 2015 On-Street Plans

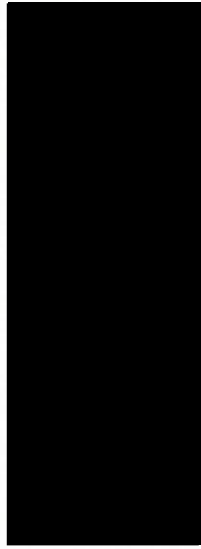

DO NOT SCALE

A3

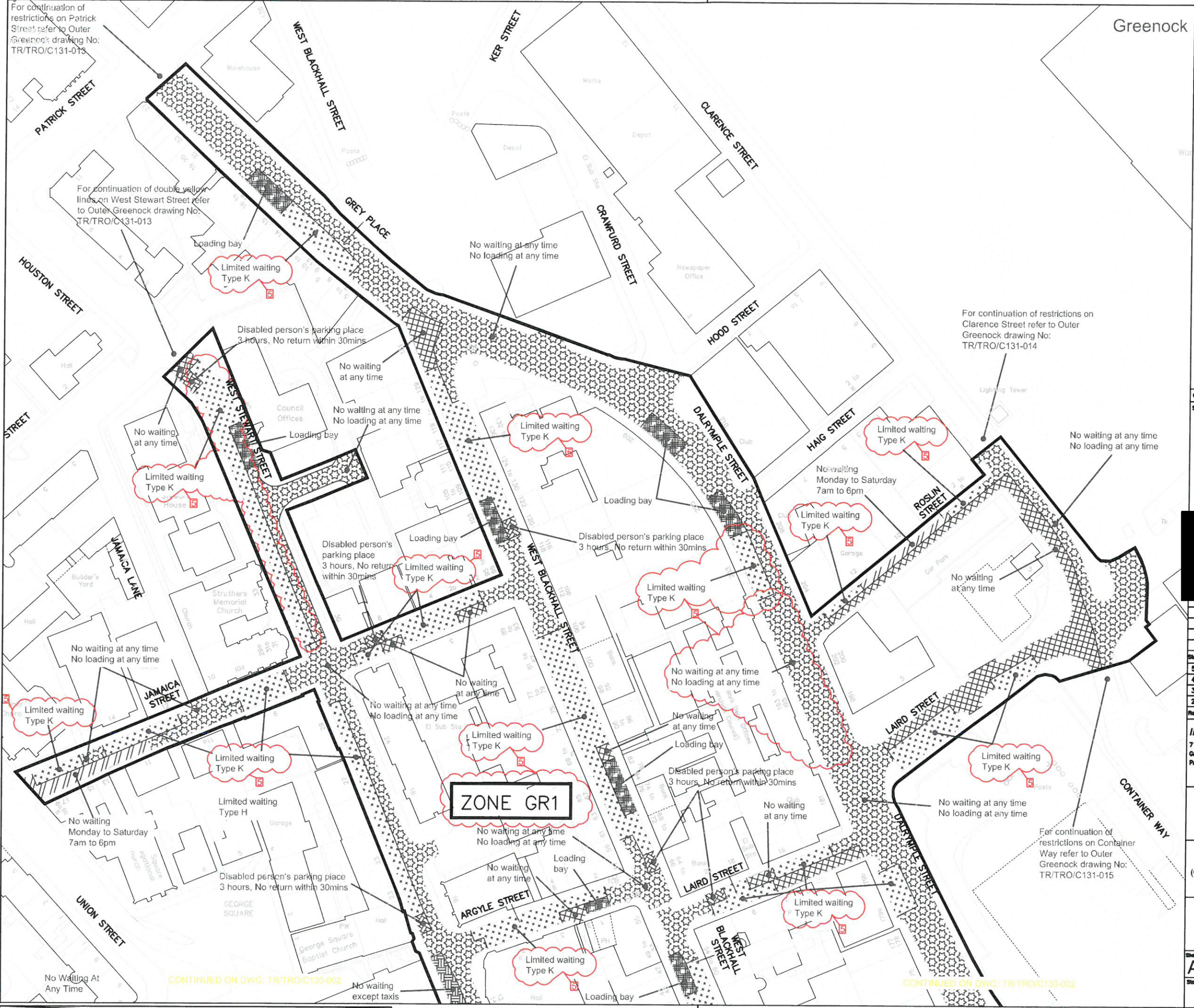

Key

- No waiting at any time
- No waiting at any time
No loading at any time
- No waiting at times shown
- No waiting at any time
No loading at times shown
- No waiting except taxis
- Limited waiting
(see below for types of limited waiting related to on these drawings)
- Parking place for permit holders
at specified times
- Disabled person's parking place
(subject to restrictions shown)
- Police parking place
(subject to restrictions shown)
- Ambulance parking place
(subject to restrictions shown)
- Loading bay
- Controlled Zone boundary
- Restricted Zone boundary

Limited Waiting
 Type A: Mon-Fri, 8am-6pm, 30mins. No return within 30mins
 Type B: Mon-Fri 8am-6pm, Saturday 8am-10am, 30mins. No return within 1 hour
 Type C: Mon-Sat 8am-6pm, 30mins. No return within 1 hour
 Type D: Mon-Sat 8am-6pm, 2 hours. No return within 1 hour
 Type E: Mon-Sat 8am to 6pm, 30 mins. No return within 30 mins
 Type F: Mon-Sat 8am to 6pm, 1 hour. No return within 30 mins
 Type G: Mon-Sat 8am to 6pm, 2 hours. No return within 30 mins
 Type H: Mon-Fri 8am to 6pm, 2 hours. No return within 30 mins
 Type J: Mon-Sat 8am to 6pm, 1 hour. No return within 1 hour
 Type K: Mon-Fri 8am to 6pm, 2 hours. No return within 30 mins except Permit Holders

© Crown copyright and database rights 2013 Ordnance Survey 100023421

Rev	Description	By	Date	Chk'd	Auth
5	PARKING PERMITS/DALRYMPL ST CHANGE	EP	JUN '15	EP	MH
4	INNER GREENOCK BOUNDARY AMENDED	EP	JUN '15	EP	MH
3	JAMAICA ST INCLUDED IN INNER ZONE	GS	DEC '14	GS	MH
2	WAITING TYPE H ADDED/JAMAICA ST REMOVED	GS	OCT '14	GS	MH

Rev	Purpose of Issue	Date	Auth
5	PARKING PERMITS/DALRYMPL ST CHANGE	EP JUN '15	EP MH
4	INNER GREENOCK BOUNDARY AMENDED	EP JUN '15	EP MH
3	JAMAICA ST INCLUDED IN INNER ZONE	GS DEC '14	GS MH
2	WAITING TYPE H ADDED/JAMAICA ST REMOVED	GS OCT '14	GS MH

INVERCLYDE COUNCIL
 71 East Hamilton Street
 Greenock
 PA15 2UA
 Tel: 01475 717171
 Email: roads@inverclyde.gov.uk
 www.inverclyde.gov.uk



THE INVERCLYDE COUNCIL (VARIOUS ROADS)
 (INNER GREENOCK)
 (CONTROLLED PARKING ZONE) (VARIATION No.5)
 ORDER 2015

EFFECTIVE DATE:

Sheet Size	Original Scale	Design/Drawn	Checked	Authorised
A3	1:1250	MJH	LM	MR
Status	Drawing Number	Date	Date	Date
P	TR/TRO/C130-001	FEB '13	FEB '13	FEB '13
Rev				
				5

CONTINUED ON DWG: TR/TRO/C130-002

CONTINUED ON DWG: TR/TRO/C130-002

DO NOT SCALE

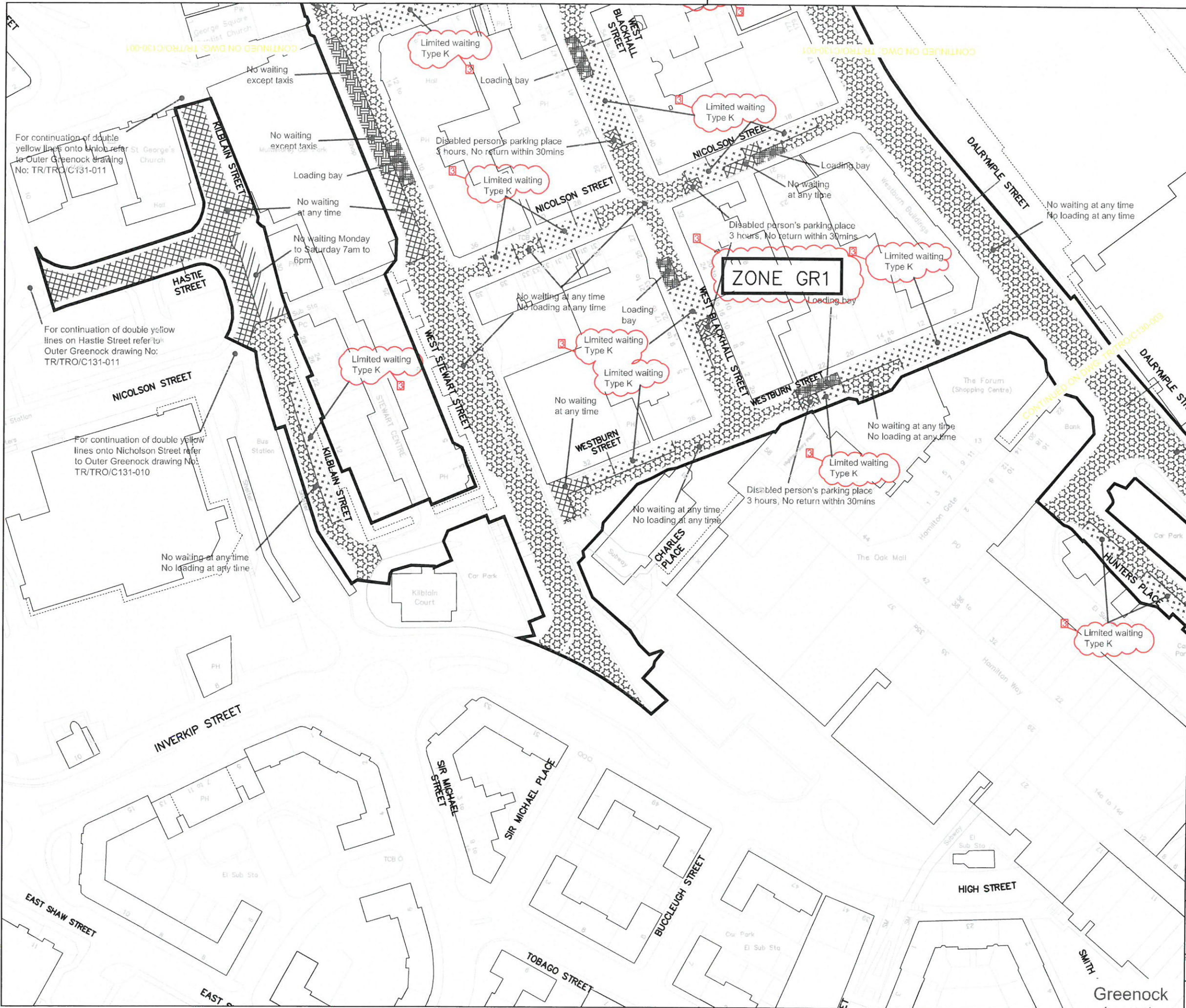

Key

- No waiting at any time
- No waiting at any time
- No loading at any time
- No waiting at times shown
- No waiting at any time
- No loading at times shown
- No waiting except taxis
- Limited waiting (see below for types of limited waiting referred to on these drawings)
- Parking place for permit holders at specified times
- Disabled person's parking place (subject to restrictions shown)
- Police parking place (subject to restrictions shown)
- Ambulance parking place (subject to restrictions shown)
- Loading bay
- Controlled Zone boundary
- Restricted Zone boundary

Limited Waiting
 Type A: Mon-Fri 8am-6pm, 30mins, No return within 30mins
 Type B: Mon-Fri 8am-6pm, Saturday 8am-1pm, 30mins, No return within 1 hour
 Type C: Mon-Sat 8am-6pm, 30mins, No return within 1 hour
 Type D: Mon-Sat 8am-6pm, 2 hours, No return within 1 hour
 Type E: Mon-Sat 8am to 6pm, 30 mins, No return within 30 mins
 Type F: Mon-Sat 8am to 6pm, 1 hour, No return within 30 mins
 Type G: Mon-Sat 8am to 6pm, 2 hours, No return within 30 mins
 Type H: Mon-Fri 8am to 6am, 2 hours, No return within 30 mins
 Type J: Mon-Sat 8am to 6pm, 1 hour, No return within 1 hour
 Type K: Mon-Fri 8am to 6pm, 2 hours, No return within 30 mins except Permit Holders

© Crown copyright and database rights 2013 Ordnance Survey 100023421



Rev	Description	By	Date	Chk'd	Auth
3	RESIDENT PARKING PERMIT SCHEME	EP	JUN '15	EP	MH
2	LIMITED WAITING TYPE H ADDED	GS	OCT '14	GS	MH
1	DISABLED BAYS REMOVED KILBLAIN COURT	MMH	MAY '14	MMH	MR

INVERCLYDE COUNCIL
 71 East Hamilton Street
 Greenock
 PA15 2UA
 Tel: 01475 717171
 Email: roads@inverclyde.gov.uk
 www.inverclyde.gov.uk



THE INVERCLYDE COUNCIL (VARIOUS ROADS)
 (INNER GREENOCK)
 (CONTROLLED PARKING ZONE) (VARIATION No. 5)
 ORDER 2015

EFFECTIVE DATE:

Sheet Size	Original Scale	Designed/Drawn	Checked	Authorised
A3	1:1250	MJH	LM	MR
Status	Drawing Number	Date	Date	Date
P	TR/TRO/C130-002	FEB '13	FEB '13	FEB '13
Rev				
				3

DO NOT SCALE

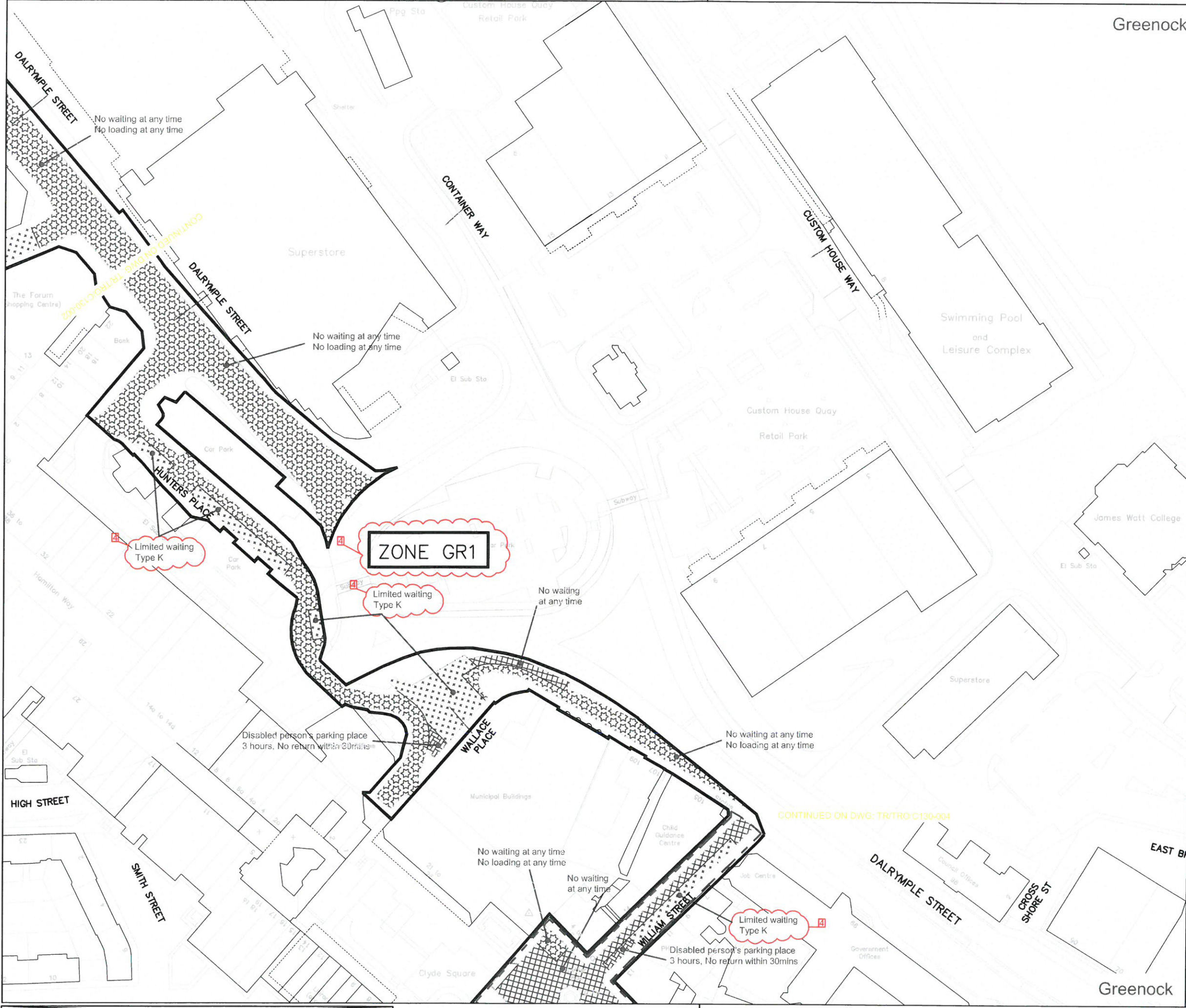

Key

- No waiting at any time
- No waiting at any time
No loading at any time
- No waiting at times shown
- No waiting at any time
No loading at times shown
- No waiting except taxis
- Limited waiting
(see below for types of limited waiting referred to on these drawings)
- Parking place for permit holders
at specified times
- Disabled person's parking place
(subject to restrictions shown)
- Police parking place
(subject to restrictions shown)
- Ambulance parking place
(subject to restrictions shown)
- Loading bay
- Controlled Zone boundary
- Restricted Zone boundary

Limited Waiting
 Type A: Mon-Fri 8am-6pm, 30mins, No return within 30mins
 Type B: Mon-Fri 8am-6pm, Saturday 8am-1pm, 30mins, No return within 1 hour
 Type C: Mon-Sat 8am-6pm, 30mins, No return within 1 hour
 Type D: Mon-Sat 8am-6pm, 2 hours, No return within 1 hour
 Type E: Mon-Sat 8am to 6pm, 30 mins, No return within 30 mins
 Type F: Mon-Sat 8am to 6pm, 1 hour, No return within 30 mins
 Type G: Mon-Sat 8am to 6pm, 2 hours, No return within 30 mins
 Type H: Mon-Fri 8am to 6pm, 2 hours, No return within 30 mins
 Type J: Mon-Sat 8am to 6pm, 1 hour, No return within 1 hour
 Type K: Mon-Fri 8am to 6pm, 2 hours, No return within 30 mins except Permit Holders

© Crown copyright and database rights 2013 Ordnance Survey 100023421

Stat

Stat	Purpose of Issue	Date	Auth
4	RESIDENT PARKING PERMIT SCHEME	EP JUN '15	EP MH
3	LIMITED WAITING TYPE H ADDED	GS OCT '14	GS MH
2	LOADING RESTRICTION ADDED CATHCART SQ	MJH MAY '14	MJH MR
1	CATHCART ST & WILLIAM ST TIME CHANGES	MJH MAY '14	MJH MR

Rev Description By Date Chk'd Auth

Stat	Purpose of Issue	Date	Auth
4	RESIDENT PARKING PERMIT SCHEME	EP JUN '15	EP MH
3	LIMITED WAITING TYPE H ADDED	GS OCT '14	GS MH
2	LOADING RESTRICTION ADDED CATHCART SQ	MJH MAY '14	MJH MR
1	CATHCART ST & WILLIAM ST TIME CHANGES	MJH MAY '14	MJH MR

INVERCLYDE COUNCIL
 71 East Hamilton Street
 Greenock
 PA15 2UA
 Tel: 01475 717171
 Email: roads@inverclyde.gov.uk
 www.inverclyde.gov.uk



THE INVERCLYDE COUNCIL (VARIOUS ROADS)
 (INNER GREENOCK)
 (CONTROLLED PARKING ZONE) (VARIATION No. 5)
 ORDER 2015

EFFECTIVE DATE:

Sheet Size	Original Scale	Designed/Drawn	Checked	Authorised
A3	1:1250	MJH	LM	MR
Status	Drawing Number	Date	Date	Date
P	TR/TRO/C130-003	FEB '13	FEB '13	FEB '13
Rev				
				4

CONTINUED ON DWG: TR/TRO/C130-004

DO NOT SCALE

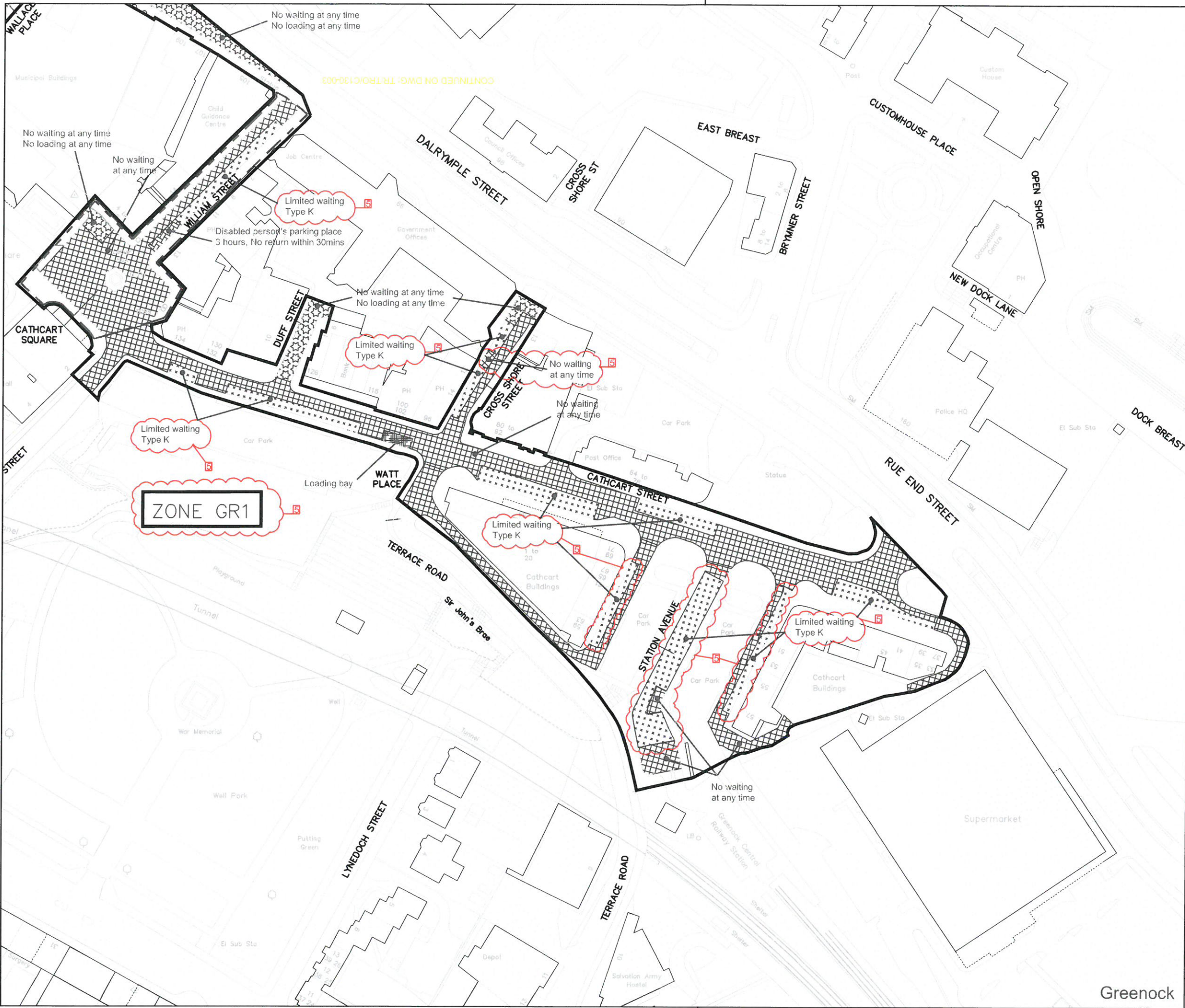

Key

- No waiting at any time
- No waiting at any time
No loading at any time
- No waiting at times shown
- No waiting at any time
No loading at times shown
- No waiting except taxis
- Limited waiting
(see below for types of limited waiting referred to on these drawings)
- Parking place for permit holders
at specified times
- Disabled person's parking place
(subject to restrictions shown)
- Police parking place
(subject to restrictions shown)
- Ambulance parking place
(subject to restrictions shown)
- Loading bay
- Controlled Zone boundary
- Restricted Zone boundary

Limited Waiting
 Type A: Mon-Fri 8am-6pm, 30mins, No return within 30mins
 Type B: Mon-Fri 8am-6pm, Saturday 8am-1pm, 30mins, No return within 1 hour
 Type C: Mon-Sat 8am-6pm, 30mins, No return within 1 hour
 Type D: Mon-Sat 8am-6pm, 2 hours, No return within 1 hour
 Type E: Mon-Sat 8am to 6pm, 30 mins, No return within 30 mins
 Type F: Mon-Sat 8am to 6pm, 1 hour, No return within 30 mins
 Type G: Mon-Sat 8am to 6pm, 2 hours, No return within 30 mins
 Type H: Mon-Fri 8am to 6pm, 2 hours, No return within 30 mins
 Type J: Mon-Sat 8am to 6pm, 1 hour, No return within 1 hour
 Type K: Mon-Fri 8am to 6pm, 2 hours, No return within 30 mins except Permit Holders

© Crown copyright and database rights 2013 Ordnance Survey 100023421

Stat	Purpose of Issue	Date	Auth		
5	PARKING PERMITS/STATION AVE/ X SHORE ST	EP JUN '15	EP MH		
4	INNER GREENOCK BOUNDARY AMENDED	EP JUN '15	EP MH		
3	LIMITED WAITING TYPE H ADDED	GS OCT '14	GS MH		
2	RESTRICTIONS ON CROSS SHORE ST AMENDED	MH MAY '14	MH MR		
Rev	Description	By	Date	Chk'd	Auth

Rev <th>Description <th>By <th>Date <th>Chk'd <th>Auth </th></th></th></th></th>	Description <th>By <th>Date <th>Chk'd <th>Auth </th></th></th></th>	By <th>Date <th>Chk'd <th>Auth </th></th></th>	Date <th>Chk'd <th>Auth </th></th>	Chk'd <th>Auth </th>	Auth

INVERCLYDE COUNCIL
 71 East Hamilton Street
 Greenock
 PA15 2UA
 Tel: 01475 717171
 Email: roads@inverclyde.gov.uk
 www.inverclyde.gov.uk



THE INVERCLYDE COUNCIL (VARIOUS ROADS)
 (INNER GREENOCK)
 (CONTROLLED PARKING ZONE) (VARIATION No. 5)
 ORDER 2015

EFFECTIVE DATE:

Sheet Size	Original Scale	Designed/Drawn	Checked	Authorised
A3	1:1250	MJH	LM	MR
Status	Drawing Number	Date	Date	Date
P	TR/TRO/C130-004	FEB '13	FEB '13	FEB '13
Rev				

Greenock

SCHEDULE 2

SCHEDULE 3

THE INVERCLYDE COUNCIL (VARIOUS ROADS) (INNER GREENOCK) (CONTROLLED PARKING ZONE) ORDER 2013 PLAN INDEX

Plan Ref.	Effective Date of original Plan	Effective Date of Plan Revision							
		1	2	3	4	5	6	7	8
TR/TRO/C130/001	06/10/2014	21/11/2014	25/05/2015	26/05/2015	24/04/2016	25/04/2016			
TR/TRO/C130/002	06/10/2014	21/11/2014	25/05/2015	25/04/2016					
TR/TRO/C130/003	06/10/2014	06/10/2014	21/11/2014	25/05/2015	25/04/2016				
TR/TRO/C130/004	06/10/2014	06/10/2014	21/11/2014	25/05/2015	24/04/2016	25/04/2016			

